

## Upload, Manage, and Share Files with an Android device

With the OneDrive App, you can access all of your OneDrive content including files shared with you. You can also view recently used documents. You can even open your OneDrive files in other iOS apps. To install the app, follow the directions below:

1. Search for the **OneDrive** app from the Google Play Store by typing “OneDrive” in the search box. Tap to select, and then install the app.

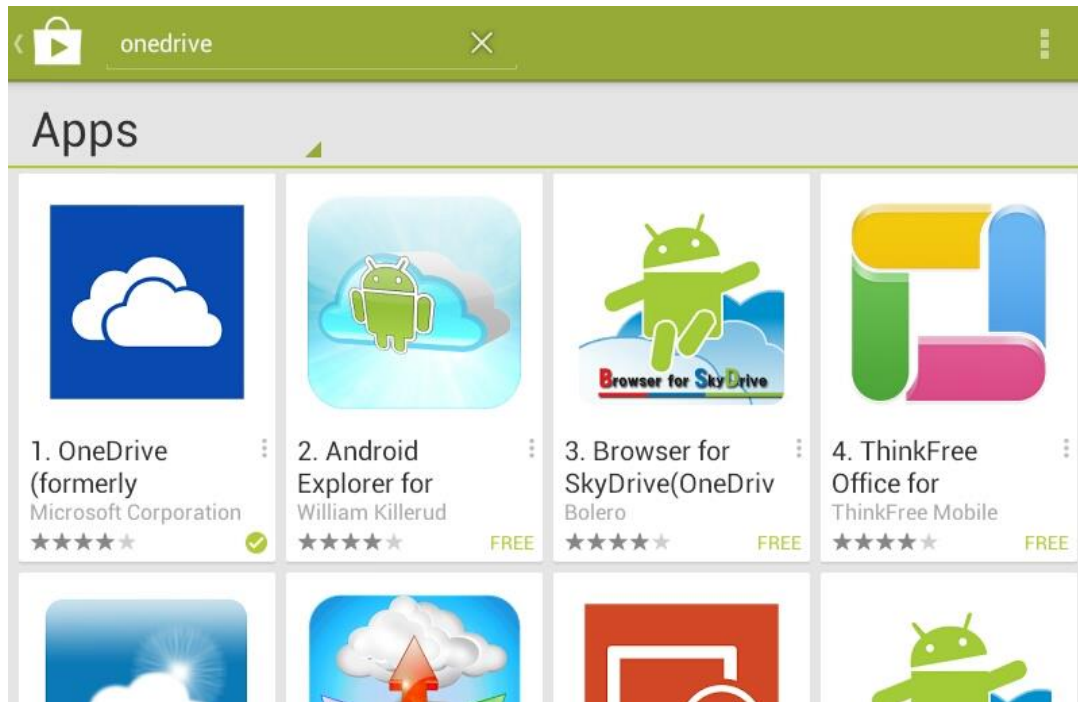

2. Once it has finished downloading, launch **OneDrive** by tapping on the app icon.



3. **Sign in to your OneDrive account.**

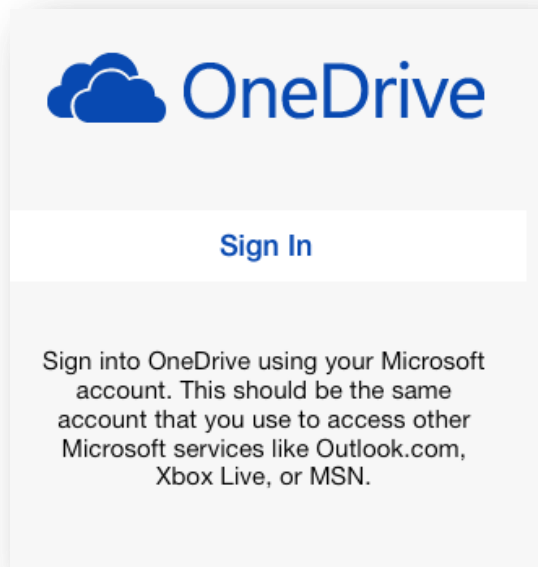

4. Choose whether or not you want your photos backed up with OneDrive.

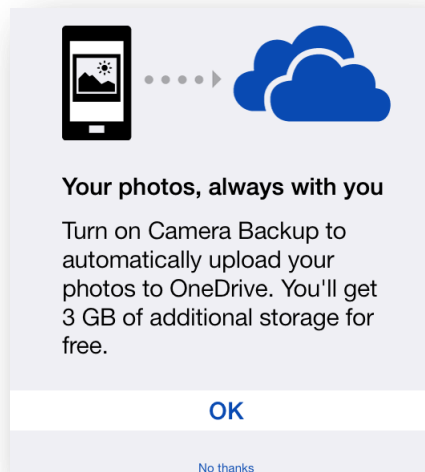

5. On the next screen, you will see the main page display your documents.

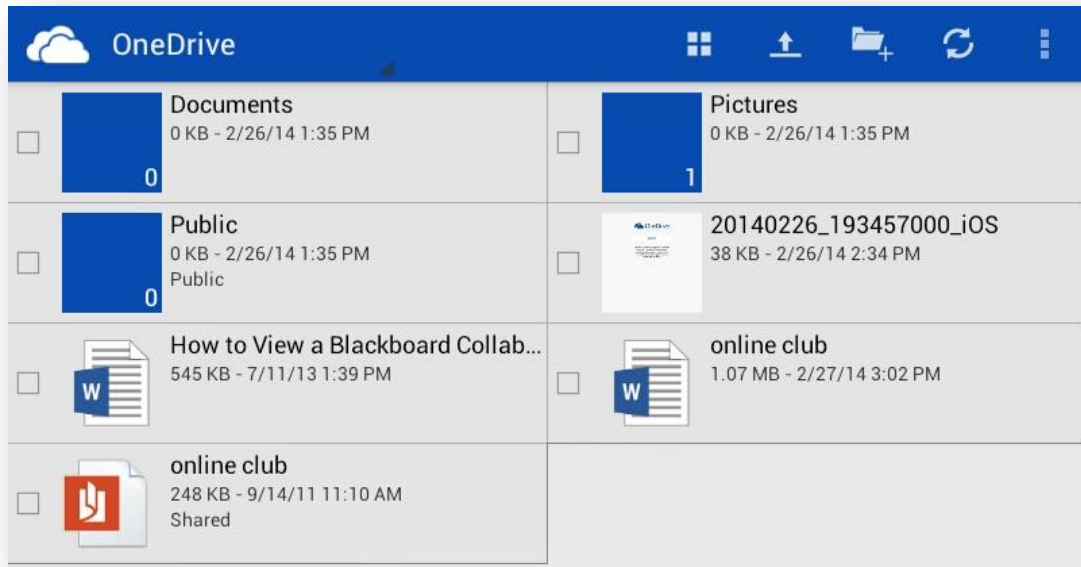

To upload to the OneDrive App, please read the next section.

## Uploading Files to OneDrive:

You can add existing photos or video from your camera roll or take new ones to share. You can even choose multiple photos or videos to upload from your device.

1. To upload a photo or video, **tap** on the arrow icon at the top. Then tap the **Upload photos and videos** or **Upload files** option.

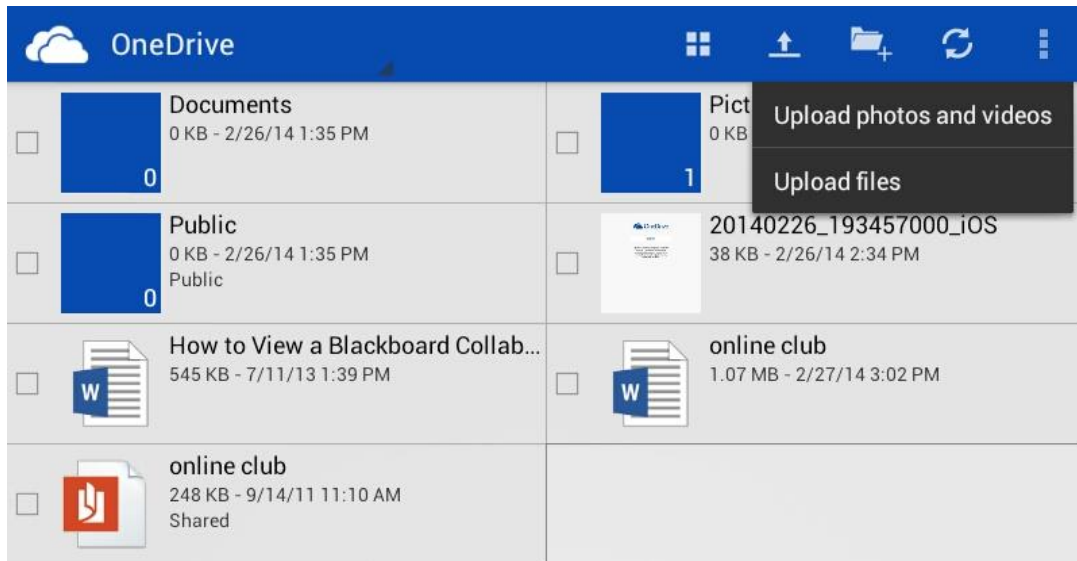

- 2.

3. Select the files you would like to upload, and then tap **Upload** in the upper right corner.

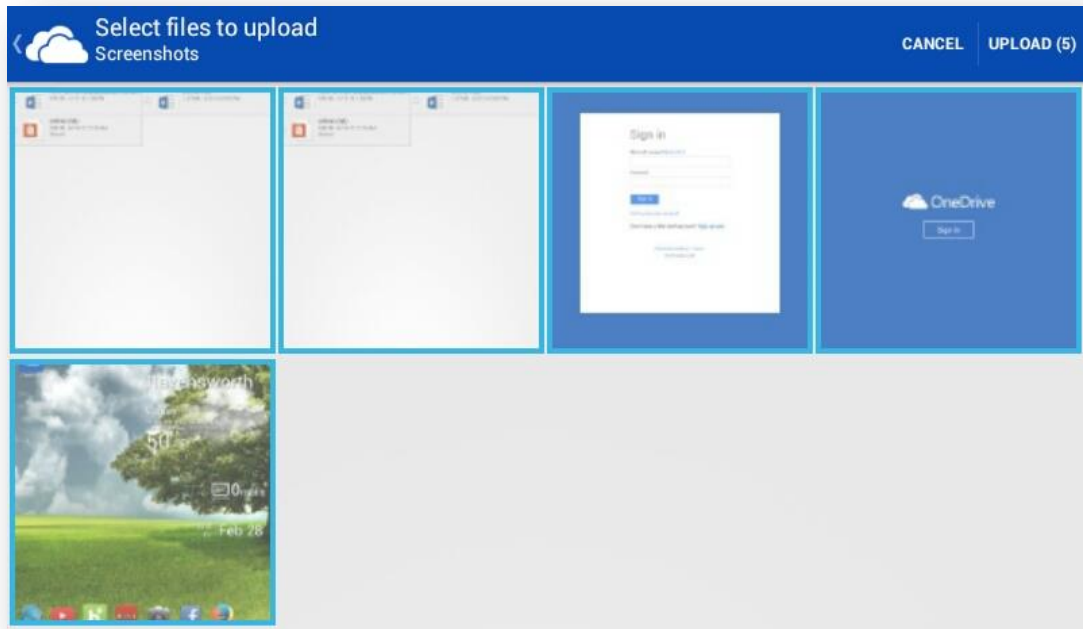

6. You will now see your files, photos or videos in your OneDrive app.

**To share from the OneDrive App, please read the next section.**

## Sharing Files in OneDrive:

With the OneDrive app, you can share any your existing files and uploaded photos. You will be able to send a link in an email or get a link you can copy and paste into other applications.

1. To share a file, **check** the box to the left of the file. Then click the link icon at the top

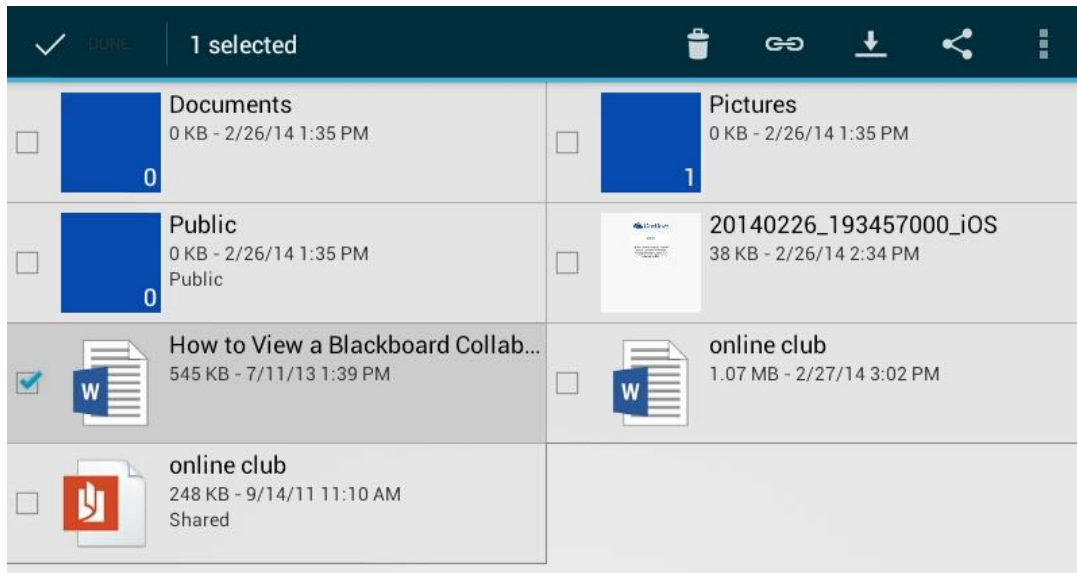

2. Choose the permissions you would like. Then tap OK.

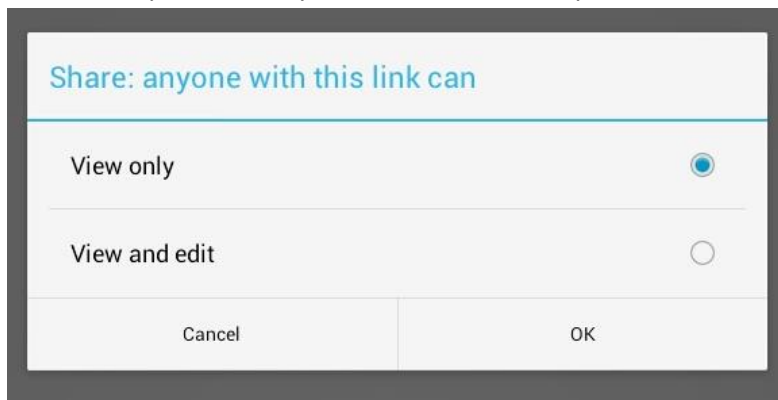

3. Choose how you would like to share your file.

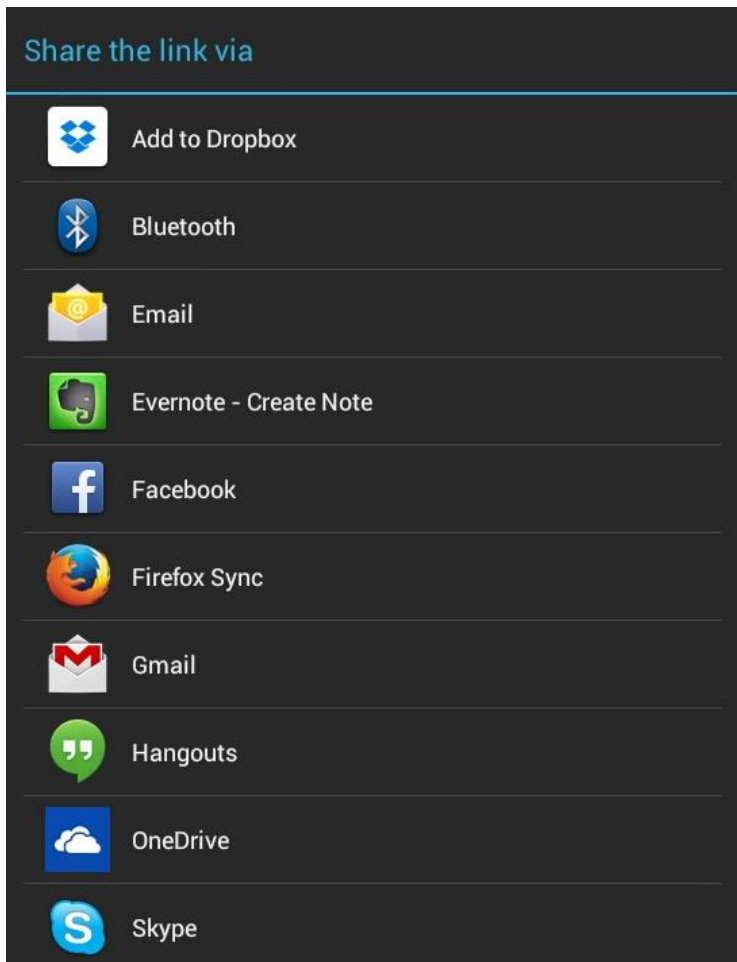

Additional resources for using **OneDrive** are available from the OneDrive website <http://onedrive.live.com/about/en-us/support/>.